

BLIND FLANGE

Nominal Pressure 6 to 40

Scope of Application

The blind flange having the dimensions of this standard and made of St.37 can be used at maximum 120 °C temperature and with working pressure stated in the table for the nominal temperature. For use at a temperature higher than 120 °C , it should be taken into consideration that the material yield point becomes low.

Form B

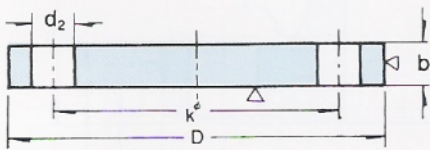

Form C

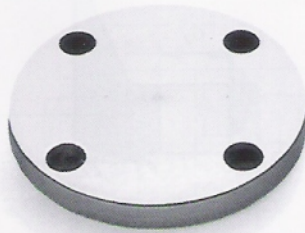
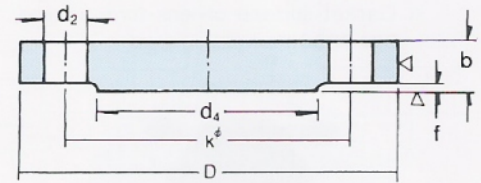

Drawing of a blind flange with its face raised (Form C) for the nominal size 250 and nominal pressure 6, made of St 37.

(Dimensions in mm)

Nominal Pressure 6											
Size	Flange			Raised face		Drilling				Approx. Weight (7.85 kg/dm ³) for	
	D	b	k	d ₁	f	Number of Holes	Bolt Diameter	d ₂	Form B kg ≈	Form C kg ≈	
10	75	12	50	35	2	4	M10	—	11.5	0.38	0.33
15	80	12	55	40	2	4	M10	—	11.5	0.44	0.38
20	90	14	65	50	2	4	M10	—	11.5	0.65	0.59
25	100	14	75	60	2	4	M10	—	11.5	0.82	0.74
32	120	14	90	70	2	4	M12	(1/2")	14	1.17	1.07
40	130	14	100	80	3	4	M12	(1/2")	14	1.39	1.21
50	140	14	110	90	3	4	M12	(1/2")	14	1.62	1.43
65	160	14	130	110	3	4	M12	(1/2")	14	2.44	2.21
80	190	16	150	128	3	4	M16	(5/8")	18	3.43	3.09
100	210	16	170	148	3	4	M16	(5/8")	18	4.76	4.37
125	240	18	200	178	3	8	M16	(5/8")	18	6.11	5.68
150	265	18	225	202	3	8	M16	(5/8")	18	7.51	7.02
(175)	295	20	255	232	3	8	M16	(5/8")	18	10.4	9.85
200	320	20	280	258	3	8	M16	(5/8")	18	12.3	11.7
250	375	22	335	312	3	12	M16	(5/8")	18	18.3	17.6
300	440	22	395	365	4	12	M20	(3/4")	23	25.3	24.0
350	490	22	445	415	4	12	M20	(3/4")	23	31.6	30.1
400	540	22	495	465	4	16	M20	(3/4")	23	38.4	36.4
500	645	24	600	570	4	20	M20	(3/4")	23	60.4	58.1
Nominal Pressure 10											
200	340	24	295	268	3	8	M20	(3/4")	23	16.5	15.6
250	395	26	350	320	3	12	M20	(3/4")	23	24.0	23.1
300	445	26	400	370	4	12	M20	(3/4")	23	30.9	29.4
350	505	26	460	430	4	16	M20	(3/4")	23	40.6	38.0
400	565	26	515	482	4	16	M24	(7/8")	27	49.4	47.5
500	670	28	620	585	4	20	M24	(7/8")	27	75.0	72.7



DIN FLANGE DIN 2527

(Dimensions in mm)

Nominal Pressure 16 *) 4 bolts for nominal pressure 10, DIN 2527											
Size	Flange			Raised face		Drilling				Approx. Weight (7.85 kg/dm ³) for	
	D	b	k	d ₄	f	Number of Holes	Bolt Diameter		d ₂	Form B kg ≈	Form C kg ≈
10	90	14	60	40	2	4	M12	(1/2")	14	0.63	0.56
15	95	14	65	45	2	4	M12	(1/2")	14	0.72	0.64
20	105	16	75	58	2	4	M12	(1/2")	14	1.01	0.93
25	115	16	85	68	2	4	M12	(1/2")	14	1.23	1.13
32	140	16	100	78	2	4	M16	(5/8")	18	1.80	1.66
40	150	16	110	88	3	4	M16	(5/8")	18	2.09	1.85
50	165	18	125	102	3	4	M16	(5/8")	18	2.88	2.59
65	185	18	145	122	3	4	M16	(5/8")	18	3.66	3.33
80	200	20	160	138	3	4*7/8	M16	(5/8")	18	4.77	4.34
100	220	20	180	158	3	8	M16	(5/8")	18	5.65	5.26
125	250	22	210	188	3	8	M16	(5/8")	18	8.42	7.67
150	285	22	240	212	3	8	M20	(3/4")	23	10.4	9.85
(175)	315	24	270	242	3	8	M20	(3/4")	23	14.0	13.5
200	340	24	295	268	3	12	M20	(3/4")	23	16.1	15.6
250	405	26	355	320	3	12	M24	(7/8")	27	24.9	23.9
300	460	28	410	378	4	12	M24	(7/8")	27	35.1	33.6
350	520	30	470	438	4	16	M24	(7/8")	27	47.8	46.2
400	580	32	525	490	4	16	M27	(1")	30	63.5	61.5
500	715	34	650	610	4	20	M30	(1 1/8")	33	102	99.5
Nominal Pressure 25 For nominal size 10-150, refer to nominal pressure 40.											
(175)	330	28	280	248	3	12	M24	(7/8")	27	17.3	16.5
200	360	30	310	278	3	12	M24	(7/8")	27	22.3	21.5
250	425	32	370	335	3	12	M27	(1")	30	33.5	32.5
300	485	34	430	395	4	16	M27	(1")	30	46.3	44.7
350	555	38	490	450	4	16	M30	(1 1/8")	33	68.0	65.9
400	620	40	550	505	4	16	M33	(1 1/4")	36	89.7	87.0
500	730	44	660	615	4	20	M33	(1 1/4")	36	138	134
Nominal Pressure 40											
10	90	16	60	40	2	4	M12	(1/2")	14	0.72	0.62
15	95	16	65	45	2	4	M12	(1/2")	14	0.81	0.74
20	105	18	75	58	2	4	M12	(1/2")	14	1.24	1.05
25	115	18	85	68	2	4	M12	(1/2")	14	1.38	1.31
32	140	18	100	78	2	4	M16	(5/8")	18	2.03	1.82
40	150	18	110	88	3	4	M16	(5/8")	18	2.35	2.11
50	165	20	125	102	3	4	M16	(5/8")	18	3.20	2.91
65	185	22	145	122	3	8	M16	(5/8")	18	4.29	4.13
80	200	24	160	138	3	8	M16	(5/8")	18	5.88	5.21
100	235	24	190	162	3	8	M20	(3/4")	23	7.54	7.08
125	270	26	220	188	3	8	M24	(7/8")	27	10.8	10.4
150	300	28	250	218	3	8	M24	(7/8")	27	14.5	13.9
(175)	350	32	295	260	3	12	M27	(1")	30	22.1	21.3
200	375	34	320	285	3	12	M27	(1")	30	27.2	26.2
250	450	38	385	345	3	12	M30	(1 1/8")	33	43.8	43.1
300	515	42	450	410	4	16	M30	(1 1/8")	33	63.3	62.2
350	580	46	510	465	4	16	M33	(1 1/4")	36	89.5	87.2
400	660	50	585	535	4	16	M36	(1 3/8")	39	127	124
500	755	52	670	615	4	20	M39	(1 1/2")	42	172	168

Nominal size in parentheses should preferably be avoided. Screw thread size in parentheses shall not be used for new construction. Material: St 37 of DIN 17100 (For other material, please specify in the order sheet).

St 37-2 for 12 °C to 300 °C temperature; Heat-treated steel for temperature over 300 °C, e.g., C22N or alloyed steel as mentioned for pipes of DIN 17175.